

# ONE BANK STREET

CANARY WHARF

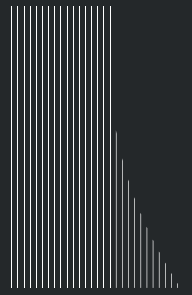

## 7th Floor Plan

32,460 sq ft / 3,016 sq m

Fixed adjustable height workstations	383	Privacy pods	6
Hot desks	40	Phone booths	8
12 person meeting rooms	2	Collaboration spaces	2
6 person meeting rooms	7	Breakout areas	4
4 person meeting rooms	8	Kitchenette	1
2 person meeting rooms	2		

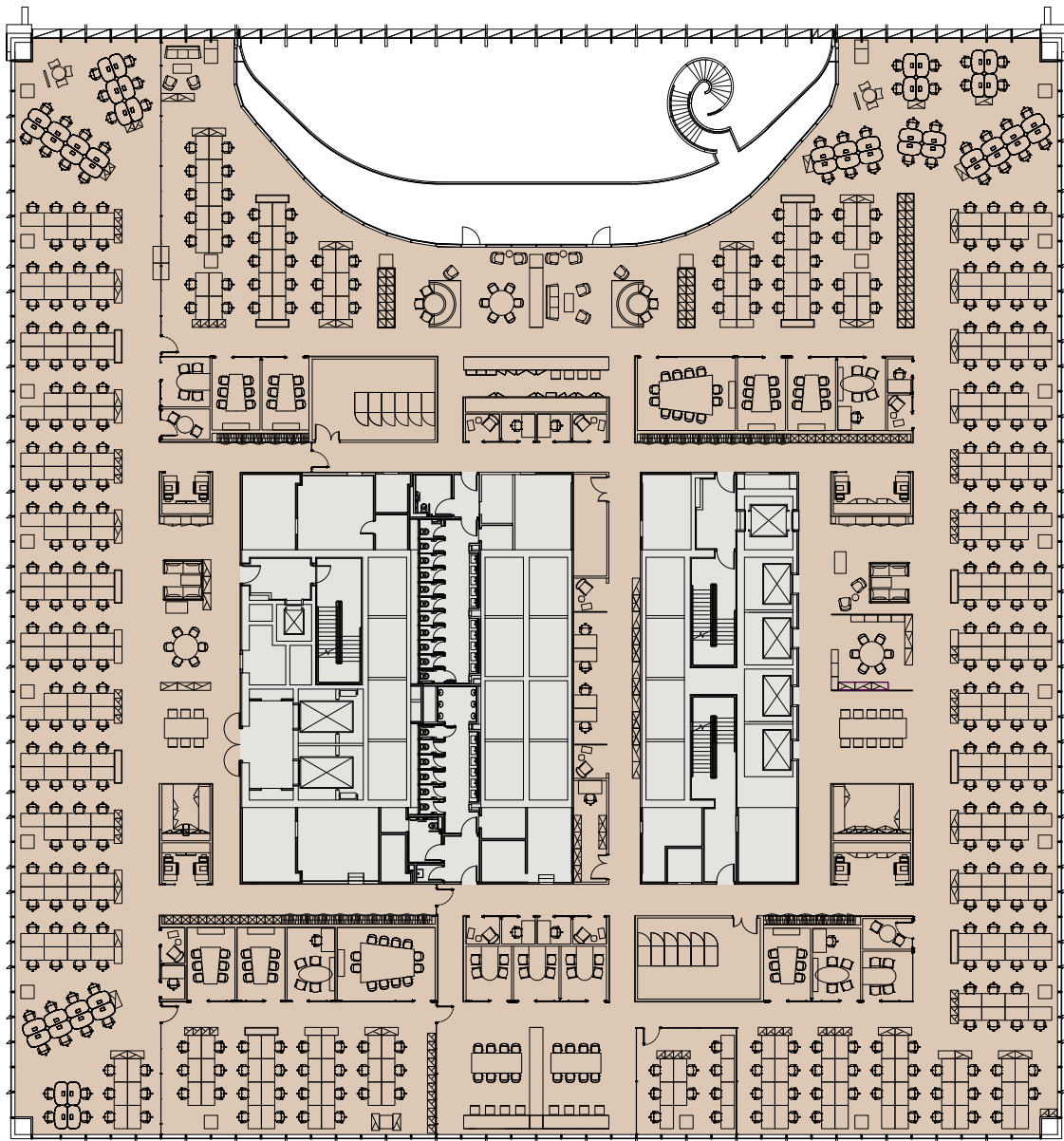

● Floor ● Core

For indicative purposes only. Not to scale.

